

ABS Plastic Case Pressure Gauge



Case material: Black abs plastic

Window: Snap-in acrylic plastic

Internals: Brass

Socket: Brass

OEM: Accept

Certification: ISO.KS

Size: According to customer needs

Gaskets Filling cap: Nitrile or Silica gel

Liquid: Glycerin or Silicone

Operating temperature: -20°C to +60°C

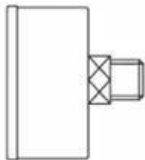

PLASTIC CASE PRESSURE GAUGES

Case: black ABS plastic

Window: snap-in acrylic plastic

Internals: brass

Socket: brass(standard);brass with PTFE ring(optional)



DIAL	CONNECTION	RANGE	THREAD	ACCURACY
1-1/2"	back	-1-700Bar or Mpa Psi mmHg kg/cm2 Kpa	1/8"	2.50%
1-1/2"	bottom		1/4"	2.50%
2"	back		3/8"	2.50%
2"	bottom		1/2"	2.50%
2-1/2"	back		NPT	2.50%
2-1/2"	bottom		BSP	2.50%
4"	back		PT	2.50%
4"	bottom			2.50%