

Low Pressure Capsule Pressure Gauge



Application

MYM-S Series is a premium capsule pressure gauge designed for use in low pressure measurement on non-corrosive and gaseous condition. Structure of black steel case or chromed steel case and bezel is applicable for dry medium that will not affect the cupreous metal sensing element. With expanded over pressure resistance, it allowed transient overpressure up to +30% of Full Scale. it is widely used in various industrial applications.

Technical Specification

Nominal Size: 63, 75, 100, 160, 200, 250 mm

Accuracy Class: Class 1.6, Class 2.5(ϕ 63,75mm);

Ingress Protection: IP 44

Connection Size: G3/8, G1/4, G1/2 or NPT or others

Scale Range: Pressure 0..16 to 0..1000 mbar; ϕ 63,75mm min range 16 mbar; Vacuum -600 mbar..0; Compound -200..+400 mbar

Tube Element Shape: Capsule type diaphragm tube

Filling: Dry type or oil filled

Operating Temperature: Ambient temperature -10°C .. $+70^{\circ}\text{C}$; Medium temperature 90°C Max.

Temperature Error: Additional error when pressure element temperature deviates from reference temperature $\pm 20^{\circ}\text{C}$ ($+68^{\circ}\text{F}$), is $\pm 0.4\%$ / 10°C (50°F) rising or falling

Over Pressure Limit: 130% of Full Scale

Dial Graduation: Black graduation on white for single range; Black and red graduation on white for dual ranges

Design Material

Casing and Bezel Ring: Black painted steel

Sensing Element: Cupreous alloy capsule

Connection: Brass

Window: Plain instrument glass

Window gasket: Industrial rubber seal

Pointer: Black painted aluminum

Dial Plate: Aluminum alloy

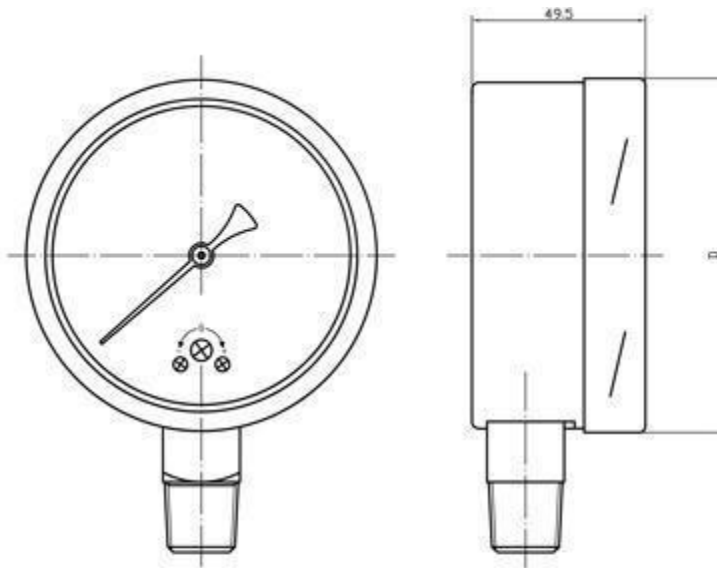

	D	H	B	B2	h1	d
2.5"	ø67	39	55	21.5	13	1/4NPT
4"	ø100	49.5	84.5	34.5	20	1/2NPT
6"	ø161	50.5	120	39.5	20	1/2NPT